

4

3

2

1

RoHS REACH compliant

| REVISION DATA | | | | |
|---------------|-----|-------------|----------|-------|
| SYM | REV | DESCRIPTION | DATE | APPR. |
| | 00 | new part | 30.03.17 | MR |
| | | | | |
| | | | | |
| | | | | |

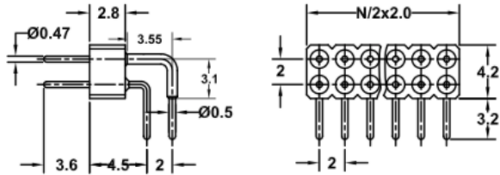

Technical Spezifications

Insulator: Black glass filled polyester PPS-GF30-FR
 Flammability: UL 94V-0
 Sleeve: Brass CuZn36Pb3(C36000)
 Mating Pin Ø: 0.47mm
 Mechanical Life: Min. 500 cycles
 Rated Current: 3 A
 Contact Resistance: Max. 10mΩ
 Dielectric Steength: Min. 1000V_{RMS}

order information

| | | | | | | |
|------------------|---|----------------|----------------|----|---|------------------|
| AP200120 | - | xx | xx | xx | - | xx |
| No. of Positions | | Plating Option | Packaging | | | Special Customer |
| 04~100 | | 01= gold flash | C= tube | | | |
| | | 100= tin | xx= on request | | | |
| | | | xx= on request | | | |

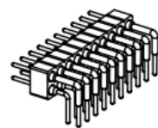

| | | | | | | |
|----------|---------------------|------------|---|--------|----------|--|
| | BRCONNECTORS | | Dual Row Precision Pin Header Right Angle Type | | | |
| | PROJECTON | | | | | |
| | DATE | 30.03.2017 | Customer Drawing-No.: | | | |
| | DRAWN | MR | Drawing-No.: 2160942 | | | |
| | CHECKED | BR | | | | |
| APPROVED | BR | | UNIT: mm | SCALE: | SIZE: A4 | |

Tolerance:
 X. ±0.50
 .X ±0.30
 .XX ±0.20
 .XXX ±0.05
 X" ±2"