

4

3

2

1



REVISION DATA				
SYM	REV	DESCRIPTION	DATE	APPR.
	00	new part	30.03.17	MR

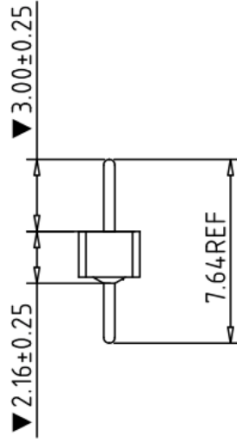
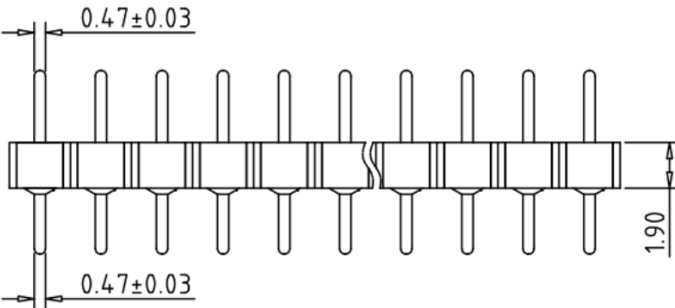
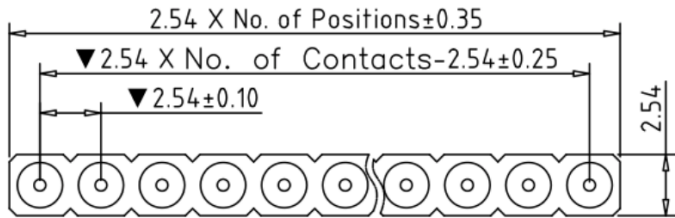

**Electrical**

**Current rating:**

**3Amps/contact max.**

**Voltage rating**

**100VRMS/150V DC**

**Contact resistance:**

**≅10Ω**

**Insulation resistance:**

**≅5000MΩ at 500V AC**

**Dielectric strength**

**1000 VRMS min.**

**Mechanical**

**Contact**

**brass JIS C3604(CuZn39Pb3)**

**black glass filled polyester,**

**PPS-GF30-FR,UL94V-0**

**Insulator**

**see ordering information**

**Plating**

**200 cycles min.**

**Mechanical life cycle**

**2.5Kg/contact min.**

**Sleeve retention force**

**≅1pF**

**Environmental**

**Operation**

**-55°C to +105°C**

**Soldering**

**245±5° 5S**

order information

AP254101	xx	xx	xx	xx
No. of Positions	Plating Option	Packaging	Special Customer	
02~40	01= gold flash	C= tube		
	100= tin	xx= on request		
		xx= on request		

**Recommended P.C.Board Hole Layout**

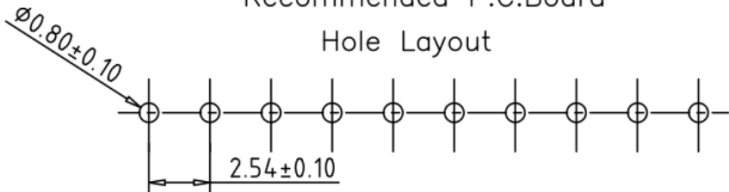

	<b>BRCONNECTORS</b>		<b>Single Row Precision Pin Header Straight Type</b>		
	PROJECTON				
	DATE	30.03.2017	Customer Drawing-No.:		
	DRAWN	MR	Drawing-No.: 2160901		
	CHECKED	BR			
APPROVED	BR	UNIT:	SCALE:	SIZE:	A4