

4

3

2

1

RoHS REACH compliant

REVISION DATA				
SYM	REV	DESCRIPTION	DATE	APPR.
	00	new part	30.03.17	MR

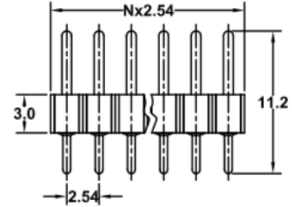
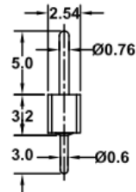

Technical Spezifications

- Insulator: Black glass filled polyester PPS+GF30
- Flammability: UL 94V-0
- Sleeve: Brass CuZn36Pb3(C36000)
- Mating Pin ϕ : 0.76mm
- Mechanical Life: Min. 500 cycles
- Rated Current: 3 A
- Contact Resistance: Max. 10m Ω
- Dielectric Steength: Min. 1000V_{RMS}

order information

AP254117	-	xx	xx	xx	xx
No. of Positions	Plating Option	Packaging	Special Customer		
01~40	01= gold flash 100= tin xx= on request	C= tube xx= on request			



Single Row Precision Pin Header Straight Type

PROJECTON	
DATE	30.03.2017
DRAWN	MR
CHECKED	BR
APPROVED	BR

Customer Drawing-No.:	
Drawing-No.:	2160974
UNIT:	mm
SCALE:	
SIZE:	A4

Tolerance:
 X. ± 0.50
 .X ± 0.30
 .XX ± 0.20
 .XXX ± 0.05
 X* $\pm 2^{\circ}$

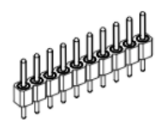

D

C

B

A

D

C

B

4

3

2

1